

# Panasonic

Operating Instructions  
(Household use) Oral Irrigator  
Model No. EW1513

English.....3

中文 .....23

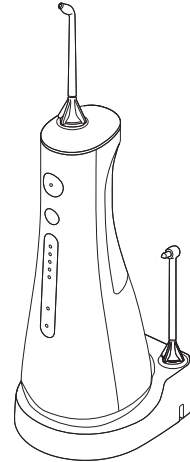



# Panasonic

Operating Instructions  
(Household use) Oral Irrigator  
Model No. EW1513

## Contents

<b>Safety precautions</b> .....	<b>4</b>	<b>Frequently asked questions</b> .....	<b>16</b>
<b>Intended use</b> .....	<b>8</b>	<b>Troubleshooting</b> .....	<b>17</b>
<b>Parts identification</b> .....	<b>9</b>	<b>Battery life</b> .....	<b>19</b>
<b>Charging</b> .....	<b>9</b>	<b>Disposal of the appliance</b> .....	<b>19</b>
<b>How to use</b> .....	<b>11</b>	<b>Specifications</b> .....	<b>20</b>
<b>Points of care</b> .....	<b>13</b>	<b>Changing the nozzle</b> <b>(Sold separately)</b> .....	<b>20</b>
<b>After use</b> .....	<b>14</b>		
<b>Wall mounting</b> .....	<b>16</b>		

Thank you for purchasing this Panasonic product.

**Before operating this unit, please read these instructions completely and save them for future use.**

## Safety precautions

To reduce the risk of injury, loss of life, electric shock, fire, and damage to property, always observe the following safety precautions.

### Explanation of symbols

The following symbols are used to classify and describe the level of hazard, injury, and property damage caused when the denotation is disregarded and improper use is performed.



## DANGER

Denotes a potential hazard that will result in serious injury or death.



## WARNING

Denotes a potential hazard that could result in serious injury or death.



## CAUTION

Denotes a hazard that could result in minor injury or property damage.

The following symbols are used to classify and describe types of instructions to be observed.



This symbol is used to alert users to a specific operating procedure that must not be performed.



This symbol is used to alert users to a specific operating procedure that must be followed in order to operate the unit safely.



## WARNING

### ► Preventing accidents

**Do not store within the reach of children or infants. Do not let them use it.**



- Doing so may cause an accident or injury due to accidental ingestion of removable parts.

### ► Power supply

**Do not connect or disconnect the adaptor or the appliance plug to a household outlet with a wet hand.**



- Doing so may cause electric shock or injury.

**Do not immerse the AC adaptor and the charging stand in water or wash it with water.**



- Doing so may cause electric shock or fire due to a short circuit.

**Do not place the AC adaptor and the charging stand over or near water filled sink or bathtub.**

**Do not use when the AC adaptor is damaged or when the fitting into the household outlet is loose.**



**Do not damage, modify, forcefully bend, pull, twist, or bundle the cord. Also, do not place anything heavy on or pinch the cord.**

- Doing so may cause electric shock or fire due to a short circuit.



## WARNING



**Do not use in a way exceeding the rating of the household outlet or the wiring.**

- Exceeding the rating by connecting too many power plugs to one household outlet may cause fire due to overheating.



**Do not use anything other than the supplied AC adaptor for any purpose. Also, do not use any other product with the AC adaptor. (See page 9.)**

- Doing so may cause burn or fire due to a short circuit.



**Always ensure the appliance is operated on an electric power source matched to the rated voltage indicated on the AC adaptor. Fully insert the adaptor.**

- Failure to do so may cause fire or electric shock.



**The supply cord cannot be replaced. If the cord is damaged, the AC adaptor should be scrapped.**

- Failure to do so may cause an accident or injury.

### ► In case of an abnormality or malfunction

**Immediately stop using and remove the AC adaptor if there is an abnormality or malfunction.**

- Failure to do so may cause fire, electric shock or injury.

**<Abnormality or malfunction cases>**



• **The main unit, adaptor, charging stand or cord is deformed or abnormally hot.**

• **The main unit, adaptor, charging stand or cord smells of burning.**

• **There is abnormal sound during use or charging of the main unit.**

- Immediately request inspection or repair to an authorized service centre.

### ► This product

**This product has a built-in rechargeable battery. Do not throw into fire or apply heat. Do not charge, use or leave in high temperature environment.**



- Doing so may cause overheating, ignition, or explosion of the built-in rechargeable battery.

**Do not modify or repair.**



- Doing so may cause fire, electric shock, or injury.

→ Contact an authorized service centre for repair (battery change, etc.).



**Never disassemble except when disposing of the product.**

- Doing so may cause fire, electric shock, or injury.



## WARNING

This appliance is not intended for use by persons (including children) with reduced physical, sensory or mental capabilities, or lack of experience and knowledge, unless they have been given supervision or instruction concerning use of the appliance by a person responsible for their safety. Children should be supervised to ensure that they do not play with the appliance.

- Failure to do so may cause an accident or injury.

### ► Cleaning

Always unplug the adaptor from a household outlet when cleaning the AC adaptor and the charging stand.

- Failure to do so may cause electric shock or injury.

Regularly clean the power plug and the appliance plug to prevent dust from accumulating.

- Failure to do so may cause fire due to insulation failure caused by humidity. Disconnect the adaptor and wipe with a dry cloth.



## CAUTION

### ► Preventing damage to teeth and gums

People who are unable to operate should not use this appliance.



People with weak oral senses should not use this appliance.

- Doing so may cause injury or damage to teeth and gums.

People who may have periodontal disease, or concerned about symptoms within their mouth should consult a dentist before use.



- Failure to do so may cause injury or damage to teeth and gums.

### ► This product

Never use for a purpose other than oral cleaning.



- Doing so may cause an accident or injury when the stream of water is pointed toward the eyes, nose, ears, tongue, or throat.

Do not fill the tank with water warmer than 40 °C.



- Doing so may cause burns.

Do not share nozzle with your family or other people.



- Doing so may cause infection or inflammation.



## CAUTION



**Do not place a metallic object such as a coin or a clip on top of the charging stand.**

- Doing so may cause burns due to excessive heat.

### ► Note the following precautions

**Do not allow metal objects or trash to adhere to the charging plug, the power plug or the appliance plug.**



- Doing so may cause electric shock or fire due to a short circuit.



**Do not drop or subject to shock.**

- Doing so may cause injury.

**Do not wrap the cord around the adaptor or the charging stand when storing.**



- Doing so may cause the wire in the cord to break with the load, and may cause fire due to a short circuit.

**Disconnect the adaptor from the household outlet when not charging.**



- Failure to do so may cause electric shock or fire due to electrical leakage resulting from insulation deterioration.

**Disconnect the adaptor or the appliance plug by holding onto it instead of the cord.**



- Failure to do so may cause electric shock or fire due to a short circuit.



**After use, clean the main unit and the nozzle and dry them.**

- Failure to do so may cause damage to your health due to propagation of mold and bacteria.

### Handling of the removed battery when disposing



## DANGER

**The rechargeable battery is exclusively for use with this appliance. Do not use the battery with other products.**

**Do not charge the battery after it has been removed from the product.**

**Do not throw into fire or apply heat.**

**Do not hit, disassemble, modify, or puncture with a nail.**



**Do not let the positive and negative terminals of the battery get in contact with each other through metallic objects.**

**Do not carry or store the battery together with metallic jewellery such as necklaces and hairpins.**

**Do not use or leave the battery where it will be exposed to high temperatures, such as under direct sunlight or near other sources of heat. Never peel off the tube.**

- Doing so may cause overheating, ignition, or explosion.

## **WARNING**

**After removing the rechargeable battery, do not keep it within reach of children and infants.**



- The battery will harm the body if accidentally swallowed.

If this happens, consult a physician immediately.

**If the battery fluid leaks out and comes in contact with the eyes, do not rub the eyes, and thoroughly rinse with clean water, such as tap water.**



- Failure to do so may cause eye injury.

Consult a physician immediately.

## **CAUTION**

**If the battery fluid leaks out and comes in contact with the skin or clothes, rinse off with clean water, such as tap water.**



- Failure to do so may cause inflammation.

## **Intended use**

- When you first begin using the oral irrigator, you may experience slight bleeding of the gums even though your gums may be healthy. This is because your gums are receiving stimulation by the oral irrigator for the first time. The bleeding should stop after one or two weeks of use. Bleeding that persists for more than two weeks may be indication of an abnormal condition of your gums, such as periodontal disease. In this case, stop using the oral irrigator and consult your dentist.
- Do not put salt, mouthwash or other chemicals into the water tank. Doing so may cause malfunction.
- Do not dry the main unit with a dryer or a fan heater. Doing so may cause malfunction or deformation of the parts.
- Oral irrigators shall be used only with cold or warm water, or specific solutions as defined in the manufacturer's instructions.
- Children shall not play with the appliance.
- Store the appliance in a place with low humidity after use. Leaving the appliance in a bathroom may cause malfunction.
- The following symbol indicates that a specific detachable power supply unit is required for connecting the electrical appliance to the supply mains. The type reference of power supply unit is marked near the symbol.



- Charge the appliance correctly according to these Operating Instructions. (See pages 9 and 10 "Charging".)
- This appliance contains battery that is only replaceable by skilled persons. Please contact an authorized service centre for the details of repair.



# Parts identification

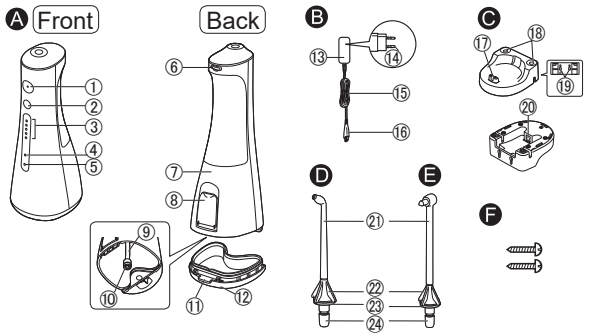

## A Main unit

- ① Power switch (Ⓚ)
- ② Level switch
- ③ Water pressure level LED indicator (1~5 levels)
- ④ Low battery indicator (blue)
- ⑤ Charge status indicator (red)
- ⑥ Nozzle release button
- ⑦ Water tank (inside)
- ⑧ Water tank cap
- ⑨ Suction hose
- ⑩ Filter
- ⑪ Bottom cover release button
- ⑫ Bottom cover

## B AC adaptor (RE7-87)

- ⑬ Adaptor
- ⑭ Power plug
- ⑮ Cord
- ⑯ Appliance plug

## C Charging stand (RC8-4)

- ⑰ Charging plug
- ⑱ Nozzle stand
- ⑲ Wall-mounting screw holes
  - The charger can be mounted on a wall using two wood screws.
- ⑳ Stand socket

## D Ultrasonic nozzle

- ⑳ Orthodontic nozzle
  - The nozzle is a consumable.
- ㉑ Nozzle
- ㉒ Nozzle Handle
- ㉓ Identification ring
- ㉔ Nozzle insertion port

## Accessory

- ㉕ 2 screws

**Note**  
There may be moisture inside the main unit (water tank and suction hose) left from the distilled water used for product testing.

# Charging

- 1 Connect the AC adaptor.**
  - ① Insert the appliance plug firmly to the stand socket.
  - ② Press the cord into either the left or right groove, depending on where it will be placed.
    - Place the charging stand on a flat and stable surface.
  - ③ Insert the adaptor into a household outlet.

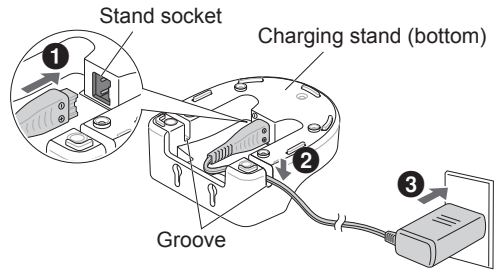

### ► About the charging time

- Charging is required when the low battery indicator (blue) flashes.
- Turning off the power switch "ⓐ" when the battery has little remaining charge, the low battery indicator will light off after 5 seconds.

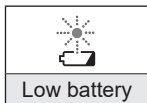





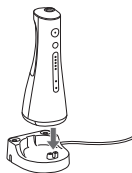

(Flashing )

## 2 Insert the main unit straight into the charging plug with the front facing outward.



### ► Indicator display during charging

		
		
Charging in progress	Charging complete	Charging abnormal (Flashing in red twice a second)

(Lights on ● Lights off ○)

(Flashing )

### ► How to check if charging is completed

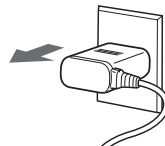

- After charging is completed, if you connect and then disconnect the main unit to and from the charging stand,  (the charge status indicator) lights on and then lights off after 5 seconds.

## 3 For safety and energy saving, disconnect the power plug.



- Charging the battery for more than 1 hour will not cause any damage to the main unit.
- **Operating time after a full charge**  
**Approx. 10 minutes\***  
(When the water pressure level is set to 5)
- \* It varies with the ambient temperature and usage conditions.
- Charging is completed after approx. 1 hour.  
(The charging time may vary with the remaining battery capacity.)

### Notes

- The charging time may differ when the appliance is used for the first time, or if it has not been used for more than 6 months.  
In addition,  (the charge status indicator) may not light on in the first several minutes of charging, but it will light on as the charging proceeds.
- The battery will deteriorate if not used for over 6 months, so make sure to perform a full charge at least once in 6 months.
- The recommended ambient temperature for charging is 10 °C - 35 °C. It may take longer to charge, or  will flash rapidly and the battery may fail to charge properly in extremely high or low temperatures.
- To keep charging the battery will not affect battery performance.

## How to use

### 1 Fill the water tank with water.

① Open the water supply cover.

② Add water while keeping the main unit level.

- Do not fill beyond the full-water position.

③ Close the water supply cover securely.

- Always use new tap water or lukewarm water.
- If the water feels cold, use lukewarm water with a temperature of 40 °C or less.

► **If the water supply cover comes off**

① Align the washer of the water supply cover with the water supply port.

② Press in until a "click" is heard.

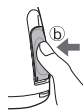
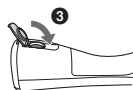

### 2 Install the nozzle.

- Choose a nozzle for your purpose. (See page 13.)

Press in firmly until a "click" is heard.



### 3 Press the level switch, and select the water pressure level.

- When you press the level switch, the water pressure level that was used last time is selected. Then each time you press the level switch, the water pressure level is switched as follows: 1 (weak) → 2 → 3 → 4 → 5 (strong) → 1...

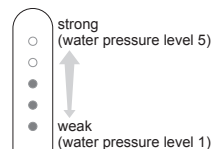
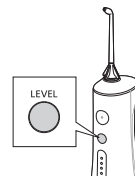

► **About the water pressure level memory function. The last selected water pressure level will be remembered, from which the appliance will start next time.**

- When the appliance has not been used for a long time or when the battery is used up, the water pressure level will return to 1.

## 4 Clean inside your mouth with water jet.

- ① Place the nozzle in your mouth.
- ② Close your mouth gently.
- ③ Turn on the power switch "①".

- You can switch the water pressure level by pressing the level switch, even while using the appliance.

- If the main unit is tilted too much, the water does not come out from the nozzle.

▶ **Operation time with full water approx. 60 seconds.**

(When the water pressure level is set to 5)

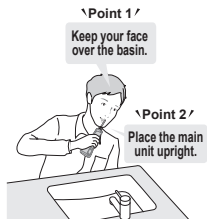

※ It can also be used in a bath.

### ▶ To adjust the orientation of the nozzle

You can adjust the direction of water jet by rotating the nozzle handle.

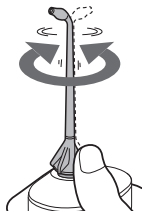

## Notes

- When using the appliance for the first time, please press the power switch "①" and check the water pressure level while water is coming out. (Please start using the appliance from water pressure level.)
- The appliance may not operate in an ambient temperature approximately 5 °C or lower. The appliance may not work outside the recommended temperature range.
- Do not push the tip of the nozzle too hard against the teeth or gums.
- When you feel that the irritation is strong, turn off the power switch "①" and use the appliance from water pressure level 1.
- Do not turn on the power switch "①" when the water tank is empty unless you are drying the moisture inside the main unit. (Doing so may cause malfunction.)

## Points of care

With the water jet and orthodontic nozzle, clean every nook and cranny of areas that are hard to reach by the toothbrush.

Change the way you use and move the unit depending on the purpose and the area you want to clean.



### Ultrasonic nozzle

**To clean with the water jet.**

#### ► Interdental cleaning

- Direct the water jet onto the space between the teeth.
- Direct from the front and rear sides of the teeth.



#### ► Periodontal pocket cleaning

- Aim the water jet at the space between teeth and gums.
- Slowly shift the water jet along the gums.
- Clean the front and back of the teeth and behind the molars as well.



#### ► Gums care

- Stimulate the gums.



If you are concerned about sensitive gums, stimulate with a gentle water jet setting.



### Orthodontic nozzle

When cleaning crooked teeth and orthodontic bracket area with the brush and water flow

**Lightly place the brush tip on the teeth and wiggle the brush.**

#### ► For crooked teeth

- Place the brush tip on the area that is difficult for a toothbrush to reach and tends to remain unpolished.
- Wiggle the brush mainly in interdental spaces.



#### For orthodontic bracket area



#### Ultrasonic nozzle

- Direct the water jet around orthodontic brackets and bridges.



#### Orthodontic nozzle

- Insert the brush to the gap between the teeth and the orthodontic bracket.
- Wiggle the brush tip.



## After use

Please clean the appliance after each use.

- 1** To prevent the water from splashing about, turn off the power switch "①" while keeping the nozzle in your mouth.



- 2** Pour out the remaining water, and wash the nozzle with water.

- ①** Open the water tank cap, and pour out the remaining water.  
 • Be sure to pour out the remaining water after each use.



- ②** Turn on the power switch "①" to drain the remaining water in the main unit.

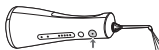

- ③** Turn off the power switch "①" when no more water comes out.

- ④** Remove the nozzle and bottom cover.  
 Wash them with water.

Pull out the nozzle while pressing the button



Nozzle release button



- 3** Remove the bottom cover, and wash the main unit (as a whole) and inside of the tank.

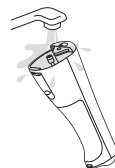

- **How to remove the bottom cover**

Bottom cover release button

Lift it up while pressing.

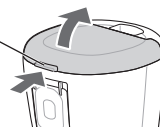

#### 4 Store it after it is dry.

- ① Wipe any water away from the nozzle and the main unit with a towel or the like, and dry them in a well-ventilated shade.
- ② Put the main unit upright on the charging stand.
  - Attach the bottom cover, and put the main unit upright on the charging stand.

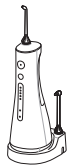
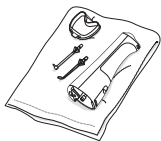

#### ► How to attach the bottom cover

- ① Insert the claws (2 places) on the front of the bottom cover into the main unit.
- ② Press in the hooks (2 places) on the back.

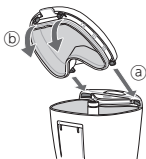

#### Notes

- Do not wash with lukewarm water exceeding 50 °C.
- Use neutral kitchen detergent and rinse well with water to ensure no detergent remains after cleaning.
- Never use thinners, benzine, or alcohol. (Doing so may cause malfunction, or cracking or discolouration of the parts.)

#### ► If the identification ring comes off

Align the nozzle with the identification ring (in any direction) to install it.

- Even if the identification ring is not attached, the performance of the nozzle is not affected.

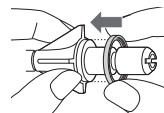

#### ► When the water jet is poor

Remove the dirt from the filter (the tip of the suction hose).

#### Filter

Rub it gently with a soft brush.

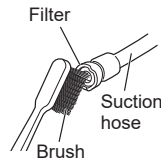

#### ► When dirt is a concern

Wipe with a dry cloth.

(Do not rinse it with water.)

#### Charging stand

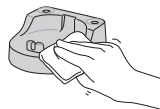

#### AC adaptor



## Wall mounting

Be sure to choose a solid wall or a crosspiece to install the charging stand.

<How to install>

- ① Tighten two wood screws (nominal diameter: 2.7 - 3.1 mm) at intervals of 29 mm so that the screw head can float about 3.0 mm from the wall.
- ② Hook the wall-mounting screw holes on the back of the charging stand on the screws, and fix them.

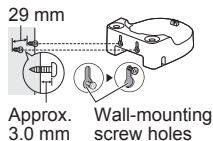

<How to remove>

- ① Lift the charging stand.
- ② Pull it forward.

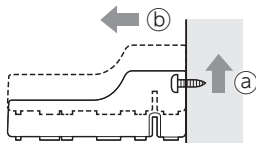

## Frequently asked questions

	Question	Answer
Battery	Will the battery be exhausted after a long period of disuse?	▶ Please charge it once every 6 months if you have not used it for over 6 months since the battery may deteriorate.
	Can the battery be charged before every use?	▶ The service life of the battery will not be affected thanks to the use of a lithium ion battery.

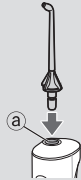

	Problem	Possible cause	Action
While charging	The charge status indicator does not light on.	▶ The appliance was just purchased or it has not been used for a while.	▶ Although the indicator may not light on in the first several minutes of charging, it will light on as the charging proceeds. If it does not light on after a while, please request a repair at your dealer or Service Centre.
	The charge status indicator flashes rapidly (twice a second).	▶ The main unit is not properly plugged in the charging stand.	▶ Check to see that the main unit stands upright so that its bottom comes in contact with the charging plug of the charging stand, and that the charge status indicator is on. (See page 10.)
		▶ The ambient temperature is too low or too high during charging.	▶ Please charge within the recommended temperature range of 10 °C to 35 °C. ▶ If the indicator flashes even when you charge it within the recommended temperature range, contact your dealer or Service Centre for repair.
	The appliance can be used for just several minutes even after a full charge.	▶ The main unit is not properly plugged in the charging stand.	▶ Check to see that the main unit stands upright so that its bottom comes in contact with the charging plug of the charging stand, and that the charge status indicator is on. (See page 10.)
The low battery indicator does not flash, but the appliance stops working.	▶ The battery has reached the end of its life (approx. 3 years).	▶ Replace it with a new one. (See page 19.) ▶ Please contact your dealer or Service Centre.	

	Problem	Possible cause	Action
While using	The appliance does not operate.	▶ The battery has reached the end of its life (approx.3 years).	▶ Please remove the built-in rechargeable battery. (See page 19.) ▶ Please contact your dealer or service centre.
		▶ The appliance is used with approximately 5 °C or lower.	▶ Do not use the appliance with approximately 5 °C or lower.
	The water jet is poor.	▶ The nozzle is clogged. The outlet of nozzle is squashed.	▶ Replace the nozzle with a new one.
		▶ The filter is clogged.	▶ Remove the dirt from the filter. (See page 15.)
		The main unit is tilted too much.	▶ Please use the appliance with the main unit upright. (See page 12.)
	No water comes out.	▶ It may take some time to suck up water.	▶ Put water into the nozzle port (a), install the nozzle, and turn on the power switch.
			
	▶ Water leaks from the bottom cover.	▶ Dirt is accumulated on the rubber part of the bottom cover.	▶ Please remove the dirt. (See page 15.)
	The nozzle is hard to install.	▶ ▶ ▶ ▶ ▶ ▶ ▶	▶ Apply water to the nozzle insertion port.

If the problems still cannot be solved, contact your dealer or a service centre authorized by Panasonic for repair.

## Battery life

Approximately 3 years. The battery may have reached its operating life if the usage frequency decreases drastically, even after a full charge.

(The operating life of the battery may differ depending on usage or storage conditions.)

## Disposal of the appliance

**Remove the built-in rechargeable battery before disposing of the appliance.**

- The battery is to be disposed of safely.
- This figure must only be used when disposing of the appliance, and must not be used to repair it.
- If you dismantle the appliance yourself, it will no longer be waterproof, which may cause it to malfunction.

### How to remove the battery

- Remove the appliance from the charging stand and adaptor, press the power switch to turn on the power and then keep the power on until the battery is completely discharged.
- Remove the bottom cover.
- Perform steps ① to ⑤ to disassemble the main unit and remove the battery with a screwdriver.
- Insulate the ⊕ and ⊖ terminals by applying tape to them. (To prevent short circuit of terminals).

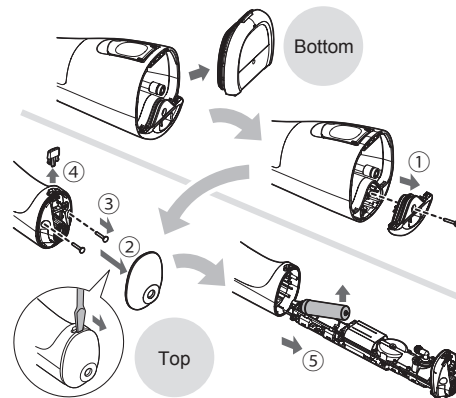

### For environmental protection and recycling of materials

This appliance contains a Lithium-ion battery. Please make sure that the battery is disposed of at an officially assigned location, if there is one in your country.

## Specifications

Power source	See the name plate on the product (Automatic voltage conversion)
Charging time	Approx. 1 hour
Operating time	LEVEL 5: Approx. 10 minutes (at 20 °C when fully charged)
Tank volume	Approx. 200 mL (For approx. 60 seconds of operation when the water pressure level is set to 5)
Dimensions	Main unit: 210 (H) x 75 (W) x 85 (D) mm (Not including nozzle) Charging stand: 40 (H) x 90 (W) x 100 (D) mm
Mass	Main unit: Approx. 275 g (Including nozzle) Charging stand: Approx. 115 g

This product is intended for household use only.

## Changing the nozzle (Sold separately)

### ► Ultrasonic nozzle

- If the tip of the nozzle gets deformed, please replace the nozzle with a new one.
- The nozzle should be replaced once every 6 months or so due to hygiene reasons, even if it is not deformed.



New nozzle (tip)



Deformed (worn) nozzle (tip)

### ► Orthodontic nozzle

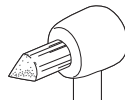

- Replace the orthodontic nozzle in approx. 3 months. If the brush bristles are bent out, replace it even within 3 months.



New nozzle (tip)

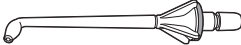

Nozzle with bent out bristles

Part number	Replacement Nozzle for EW1513	
WEW0983	Ultrasonic nozzle	
WEW0984	Orthodontic nozzle	



## 目錄

安全注意事項.....	24	掛牆 .....	36
使用須知 .....	28	常見問題 .....	36
部件名稱 .....	29	疑難排解 .....	37
充電 .....	29	電池壽命 .....	39
如何使用 .....	31	棄置本電器.....	39
護理重點 .....	33	規格 .....	40
使用後.....	34	更換噴嘴 (須另行購買) .....	40

多謝您購買本 Panasonic 產品。  
操作本產品之前，請仔細閱讀本說明書。請妥善保存本說明書以供未來使用。

## 安全注意事項

為減低觸電、受傷、火災、死亡及財物損失的風險，請務必遵照以下安全預防措施。

### 符號說明

以下符號用於為危險、傷害及財物損失的級別分類和作出解釋。若不理會此等符號，不當使用本產品就可能導致所述的危險、人身傷害及財物損失。



**危險**

表示潛在的危險會導致嚴重受傷或致命。



**警告**

表示潛在的危險可能會導致嚴重受傷或致命。



**注意**

表示可能會導致輕微受傷或財產損失。

以下符號用於分類和解釋必須留意的指示類型。



此符號用於提示用戶，不得執行某項特定的操作程序。



此符號用於提示用戶，必須遵從某項特定的操作程序，藉以安全操作本產品。



## 警告

### ▶ 預防意外



切勿將產品存放於兒童或幼童可觸及的地方。請勿讓兒童或幼童使用。

- 否則可能因不小心誤食可拆除之零件而導致意外或受傷。

### ▶ 電源



請勿在手濕時將轉接器或產品插頭插入家用插座，或者從家用插座中拔出。

- 否則可能會導致觸電或受傷。



請勿將電源供應器及充電座浸入水中或用水清洗。

- 否則可能會因短路而導致觸電或火警。



請勿將電源供應器及充電座置於裝有水的洗手盆或浴缸上方或附近。

如果電源供應器損毀，或者在插入家用插座時鬆脫，請勿使用本產品。

請勿損毀、改裝、強行彎曲、拉扯、扭曲或捆紮電源線。此外，切勿將重物放在電源線上或夾緊電源線。

- 否則可能會因短路而導致觸電或火警。



## 警告

切勿以超出家用電源插座或配線額定值的方式使用產品。



- 將太多電源插頭插入同一個插座上，以致超出額定值，可能會因過熱而導致火警。

除了隨產品附上的電源供應器外，在任何情況下請勿使用任何其他電源供應器。此外，請勿使用隨產品附上的電源供應器為其他產品充電。



(請參閱第 29 頁。)

- 否則可能會因短路而導致灼傷或火警。

必須確保操作電器的電源，與電源供應器上所示的額定電額相符。



將電源插頭完全插入。

- 否則可能會導致火警或觸電。

電源線無法更換。如果電源線損壞，則應棄置該電源供應器。



- 否則可能會導致意外或受傷。

## ► 如有異常或故障

若產品出現異常或故障情況，請立即停止使用產品並拔除電源供應器。

- 否則可能會導致火警、觸電或受傷。

<異常或故障情況>



• 主機、轉接器、充電座或電源線已變形或異常灼熱。

• 主機、轉接器、充電座或電源線發出燃燒的氣味。

• 主機在使用或充電時發出異常聲響。

- 請立即將產品帶往客戶服務中心，以作檢查或維修。

## ► 本產品

本產品附上內置充電式電池。請勿將本產品丟入火源或加熱。請勿在高溫環境下充電、使用或放置本產品。



- 否則可能會導致內置充電電池過熱、燃燒或爆炸。

切勿改裝或自行維修產品。



- 否則可能會導致火警、觸電或受傷。

→ 請聯絡客戶服務中心以作維修（更換電池等）。

## 警告

-  切勿拆卸本產品，棄置時除外。  
- 否則可能會導致火警、觸電或受傷。

-  本產品不宜供肢體、感官或精神上有障礙、或缺乏經驗及知識等人士（包括兒童）使用，必須有監護人從旁監督，並指導使用本產品，且能承擔使用者安全的責任。並應妥善照顧兒童，確保他們不會把玩本產品。  
- 否則可能會導致意外或受傷。

### ▶ 清潔

-  清潔電源供應器及充電座期間，請勿將電源供應器連接到家用插座。  
- 否則可能會觸電或受傷。

應定期清潔電源插頭及電源線插頭，以避免積聚灰塵。

-  - 否則濕氣可能會令絕緣失效而導致起火。  
請移除轉接器的連接，並用乾布擦拭。

## 注意

### ▶ 預防牙齒及牙齦受損

-  無操作能力的人士不得使用本產品。  
口腔感覺能力弱的人士不得使用本產品。  
- 否則可能會導致受傷，或者牙齒及牙齦受損。

-  可能患有牙周疾病或擔心口內症狀的人士，在使用本產品前，應先諮詢牙醫意見。  
- 否則可能會導致受傷，或者牙齒及牙齦受損。

### ▶ 本產品

-  除清潔口腔外，請勿用於任何其他用途。  
- 請勿將水柱指向眼睛、鼻子、耳朵、舌頭或喉嚨，否則可能會導致意外或受傷。

## 注意

-  請勿在水箱內注入溫度高於 40 °C 的水。  
- 否則可能會導致灼傷。
-  請勿與家人或其他人士共用同一個噴嘴。  
- 共用噴嘴可能會導致感染或發炎。
-  切勿將金屬物件（例如硬幣或萬字夾）放在充電座上。  
- 否則可能會因過熱而導致灼傷。
- ▶ 請注意以下事項
-  切勿讓金屬物件或垃圾貼附在充電插頭、電源插頭或電源線插頭上。  
- 否則可能會因短路而導致觸電或火警。
-  切勿將產品摔落或使其受到撞擊。  
- 否則可導致受傷。
-  請勿在存放時將電線纏繞在轉接器或充電座上。  
- 否則可令電源線內的導線因受壓而斷裂，並可能因短路而導致火警。
-  不充電時，請從家用插座拔除轉接器。  
- 否則可因絕緣劣化造成漏電，導致觸電或火警。
-  請握住轉接器或電源線插頭拔除電源，請勿拉扯電源線。  
- 否則可能會導致觸電，或者因短路而造成火災。
-  使用過後，請清潔主機和噴嘴，然後風乾。  
- 否則可能會導致黴菌或細菌滋生，因而令您的健康受到損害。

## 如何處置從廢棄產品中拆下的電池

### 危險

本充電電池僅能用於搭配此本產品使用。請勿將本電池搭配其他產品使用。

將電池從產品拆除後，請勿進行充電。

請勿丟入火中或加熱。

請勿撞擊、拆解、改裝或以指甲穿刺。

 請勿讓電池的正極和負極端子透過金屬物質相互接觸。

請勿將電池與金屬飾品，如項鍊及髮夾等一起攜帶或存放。

切勿在高溫的位置使用或放置電池，例如在陽光直射或靠近其他熱源的地方。

請勿剝下電池直流管。

- 否則可導致過熱、燃燒或爆炸。

## 警告

拆除充電電池後，切勿放在孩童或嬰兒可取得的地方。

-  若意外吞下電池，會傷害身體。  
若發生此狀況，請立即就醫。

若電池液體外漏且接觸到眼睛，請勿揉搓眼睛，並使用清水（如自來水）徹底沖洗。

-  否則可能會導致眼睛受傷。  
請立即就醫。

## 注意

若電池液體外漏且接觸到皮膚或衣物，請使用清水（如自來水）沖洗。

-  否則可能導致發炎。

## 使用須知

- 第一次使用沖牙機時，您可能會遇到牙齦輕微出血的情況，即使您的牙齦相當健康亦然。這是因為您的牙齦第一次受到沖牙機的刺激。使用一至兩週之後，出血情況應會停止。如果出血情況超過兩週，就可能表示您的牙齦出現異常症狀，例如牙周病等。在這種情況下，請停止使用沖牙機並前往牙科診所就醫。
- 請勿將鹽、漱口水或其他化學物質放入水箱之中，否則可能會導致故障。
- 請勿用風筒或暖風機弄乾主機，否則可能會導致故障或零件變形。
- 沖牙機只應配合冷水或暖水，或符合生產商指引的指定清潔液使用。
- 兒童不能把玩本產品。
- 使用後，請將本產品存放在濕度低的地方。將本產品置於浴室，可能會導致故障。
- 下列符號表示需使用專用的可拆式電源供應器，將本電器連接至主電源。符號附近會標示電源供應器的類型參考。



- 根據這些使用說明書所示，將產品正確充電。（請參閱第 29 頁及 30 頁「充電」。）
- 本產品含有只能交由專業人員更換的電池。如需詳細的維修資訊，請洽詢客戶服務中心。

## 部件名稱

### A 正面

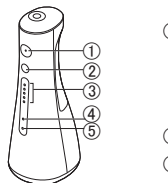

### 背面

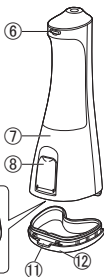

### B

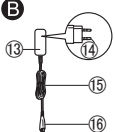

### C

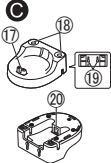

### D

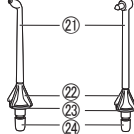

### E



### F



### A 主機

- 1 電源開關 (①)
- 2 水壓級別開關 (LEVEL)
- 3 水壓級別 LED 指示燈 (1~5 級)
- 4 電力不足指示燈 (藍色)
- 5 充電狀態指示燈 (紅色)
- 6 噴嘴釋放按鈕
- 7 水箱 (內部)
- 8 水箱蓋
- 9 吸入管
- 10 過濾器
- 11 底蓋釋放按鈕
- 12 底蓋

### B 電源供應器 (RE7-87)

- 13 轉接器
- 14 電源插頭
- 15 電源線
- 16 電源線插頭

### C 充電座 (RC8-4)

- 17 充電插頭
- 18 噴嘴收納孔
- 19 掛牆用螺絲孔
  - 可用兩顆木螺絲將充電器安裝於牆上。
- 20 充電座插座

### D 超聲波噴嘴

- ### E 矯齒噴嘴
- 噴嘴屬於消耗品
  - 21 噴嘴
  - 22 噴嘴柄
  - 23 識別環
  - 24 噴嘴插入口

### 配件

- ### F 掛牆用木螺絲 (×2)

## 註

主機內部 (水箱及吸入管) 可能會有水分, 這是用於產品測試的殘餘蒸餾水。

## 充電

### 1 連接電源供應器。

- 1 將電源線插頭牢牢插入充電座插座上。
- 2 根據產品放置的位置, 將電源線壓入左側或右側溝槽內。
  - 將充電座放置於平坦、穩定的平面上。
- 3 將轉接器插入家用插座。

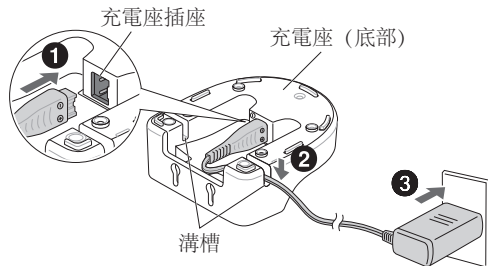

### ▶ 有關充電時間

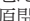
- 電力不足指示燈（藍色）閃爍時，即代表需要充電。
- 電池的剩餘容量不足時，請關閉電源開關「」，電力不足指示燈將於 5 秒後熄滅。

## 2 將主機垂直插入充電插頭，正面朝外。







電力不足

(閃爍 )



### ▶ 充電時的指示燈顯示方式

	
	
充電中	充電完成

(亮起 ● 熄滅 ○)

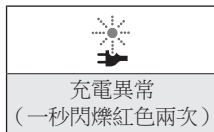

充電異常  
(一秒閃爍紅色兩次)

(閃爍 )

### ▶ 如何檢查充電是否完成

- 充電完成後，先拿起主機，然後將主機重新連接至充電座，（充電狀態指示燈）會亮起，並於 5 秒後熄滅。

## 3 為確保安全及省電，請於充電後拔除電源插頭。

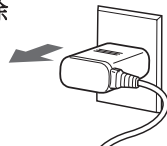



- 為電池充電 1 小時以上，並不會令主機損壞。

### ▶ 充滿電後的操作時間 大約 10 分鐘\*

(水壓級別為 5 時)

- \* 實際情況會隨著環境溫度及使用狀況而有所改變。
- 大約在 1 小時後完成充電。  
(充電時間可能會隨著剩餘電池容量而改變。)

### 註

- 如第一次使用本產品，或者不使用本產品超過六個月，充電時間可能會有所不同。此外，（充電狀態指示燈）可能不會在充電的最初數分鐘亮起，但會隨著充電過程而逐漸亮起。
- 如超過六個月未使用本產品，電池將會劣化，因此請確保最少每六個月徹底充電一次。
- 建議的充電環境溫度為 10 °C - 35 °C。在極高或極低溫度下，充電時間可能會延長，或者  快速閃爍且電池無法正常充電。
- 持續為電池充電，將不會影響電池性能。

# 如何使用

## 1 在水箱內注入清水。

① 打開水箱蓋。

② 將主機保持水平狀態，然後裝入清水。

• 請勿注水至超過滿水位置。

③ 牢牢關上水箱蓋。

• 確保使用乾淨的自來水或暖水。  
• 如果感覺水溫較涼，可使用不超過 40 °C 的暖水。

### ► 如果水箱蓋掉落

① 將水箱蓋的墊圈對齊水箱口。

② 壓入水箱口，直到聽到「咔」聲。

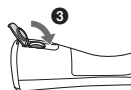

## 2 安裝噴嘴。

• 為您的特定用途選擇所需噴嘴。（請參閱第 33 頁。）

牢牢按入，  
直至聽到  
「咔」聲。



## 3 按下水壓級別開關，然後選擇所需的水壓級別。

• 按下水壓級別開關時，系統會自動選擇上次使用的水壓級別。每次按下水壓級別開關時，系統會依照以下次序切換水壓級別：1（弱）→ 2 → 3 → 4 → 5（強）→ 1...

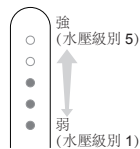
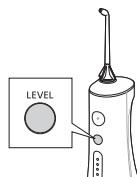

► 關於水壓級別記憶功能：系統會自動記錄上次選擇的水壓級別。當再次啟動時，將會由此水壓級別開始啟動。

• 本產品長時間未使用或電池耗盡時，水壓級別將會回到 1。

#### 4 使用水柱清潔口腔。

- 1 將噴嘴放入口中。
- 2 輕輕閉上嘴巴。
- 3 開啟電源開關「①」。

- 您可按下水壓級別開關切換水壓級別，甚至在使用產品時也可切換。
- 如果主機太過傾斜，噴嘴便不會噴水。

▶ 水箱滿水時的操作時間大約為 60 秒。

(水壓級別設定為 5)



※ 也可以在浴缸內使用。

#### ▶ 調整噴嘴方向

您可旋轉噴嘴柄，調整水柱方向。

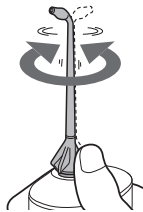

#### 註

- 第一次使用本產品時，請按下電源開關「①」，然後在噴水時檢查水壓。(請由水壓級別 1 開始使用本產品。)
- 在室溫 5 °C 或以下時，本產品可能無法運作。本產品可能無法在建議溫度範圍以外的溫度中運作。
- 請勿對著牙齒或牙齦過度推擠噴嘴的尖端。
- 如果覺得刺激過於強烈，請關閉電源開關「①」，然後由水壓級別 1 開始使用本產品。
- 除非您要將主機內部的水分排出，否則請勿在沒有注入清水的情況下開啟電源開關「①」(否則可導致故障)。



## 護理重點

使用水柱及矯齒噴嘴，清潔牙刷難以接觸的每個角落和窄小部位。

視乎清潔目的及您想清潔的部位而定，您可改變本產品的使用方法，並隨意移動機身。



### 超聲波噴嘴

使用水柱清潔。

#### ▶ 清潔牙縫

- 直接將水柱對準牙齒之間的罅隙。
- 指向牙齒的正面和背面。



#### ▶ 清潔牙周袋

- 將水柱對準牙齒與牙齦之間的罅隙。
- 沿著牙齦緩慢移動水柱。
- 清潔牙齒的正面和背面，以及清潔白齒背面。



#### ▶ 牙齦護理

- 護理牙齦。



假如您擔心牙齦敏感，請使用較低的水壓設定加以刺激。



### 矯齒噴嘴

以刷頭及水流清潔不整齊的牙齒，及清潔矯正托架部位時使用

將刷頭的尖端輕輕放在牙齒上，然後擺動刷頭。

#### ▶ 用於不整齊的牙齒

- 將刷頭尖端放在牙刷難以接觸，且通常沒有洗擦的部位上。
- 主要在牙縫位置擺動刷頭。



#### 用於矯正托架部位



#### 超聲波噴嘴

- 將水柱噴向矯正托架及牙橋的周圍。



#### 矯齒噴嘴

- 將刷頭放入牙齒與矯正托架之間的罅隙中。
- 擺動刷頭尖端。



## 使用後

請在每次使用過後清潔本產品。

- 1** 為了避免濺水，請在噴嘴仍放在口中時關閉電源開關「①」



- 2** 請倒掉剩餘水分，然後用水清洗噴嘴。

- ①** 打開水箱蓋，倒出餘下的水分。  
• 每次使用後，應確保倒出餘下的水分。



- ②** 開啟電源開關「①」，排出主機內餘下的水分。



- ③** 沒有水分排出後，請關閉電源開關「①」。

- 4** 取下噴嘴及底蓋。  
用水清洗。

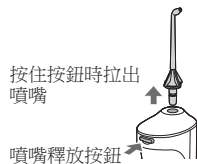

- 3** 取下底蓋，然後清洗主機及水箱內部。



### ► 如何取下底蓋

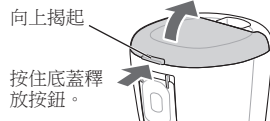

#### 4 乾燥後妥善存放。

- 1 使用毛巾或類似物品擦乾噴嘴及主機上的水分，然後放在通風良好的陰涼處風乾。
- 2 將主機豎立在充電座上。
  - 安裝底蓋，然後將主機豎立在充電座上。

#### ► 如何安裝底蓋

- a 將底蓋正面的固定爪（2 處）插入主機。
- b 壓入背面的固定鉤（2 處）。

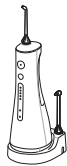
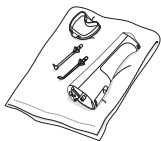

#### 註

- 請勿使用溫度高於 50 °C 的暖水清洗。
- 請使用中性的廚房洗潔精及清水沖洗，並確保清潔後不會殘留洗碗精。
- 切勿使用稀釋劑、汽油或酒精。  
（否則可能會導致故障，或者零件斷裂或褪色。）

#### ► 如果識別環掉落

請將噴嘴對齊識別環（任何方向）將其裝入。

- 即使未安裝識別環，噴嘴的性能也不會受到影響。

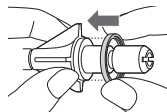

#### ► 水柱無力時

請清除過濾器上的污垢（吸入管的尖端）。

#### 過濾器

使用軟刷輕輕擦拭。

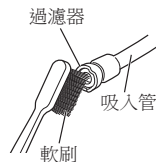

#### ► 充電座、電源供應器航髒時

請用乾布擦拭  
（請勿用水沖洗）。

#### 充電座

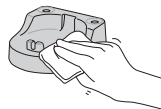

#### 電源供應器



## 掛牆

請確保選擇實心牆壁或橫梁，以安裝充電座。

<如何安裝>

- 1 在牆上安裝掛牆用木螺絲，兩顆木螺絲（標稱直徑：2.7-3.1 mm）之間的距離為 29 mm，然後鎖緊木螺絲讓螺絲頭露出牆壁 3.0 mm。

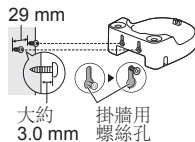

- 2 將掛牆用螺絲孔確實裝入牆壁的螺絲頭上，然後將充電座下壓固定位置。

<如何取下>

- a 將充電座向上拉起。
- b 向前拉出。

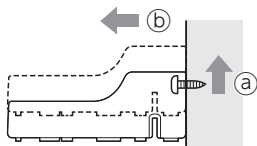

## 常見問題

	問題	答案
電池	若長期不使用，電池電量會否耗盡？	▶ 如果超過 6 個月未使用本產品，請每 6 個月充電一次，以免電池劣化。
	可否在每次使用之前為電池充電？	▶ 本產品使用鋰電池，其使用壽命並不會因此而受影響。

## 疑難排解

	問題	可能成因	解決辦法
充電時	充電狀態指示燈沒有亮起。	▶ 剛購買本產品，或者有一段時間沒有使用本產品。	▶ 雖然指示燈可能不會在充電的頭幾分鐘亮起，但會隨著充電過程而逐漸亮起。如果在一段時間後仍未亮起，請前往經銷商或客戶服務中心以作維修。
		▶ 主機未正確插入充電座。	▶ 請查看主機是否豎直，讓底部接觸到充電座的充電插頭，且充電狀態指示燈已經亮起。 (請參閱第 30 頁。)
	充電狀態指示燈快速閃爍(一秒兩下)。	▶ 充電時的環境溫度過低或過高。	▶ 請在 10 °C 到 35 °C 的建議溫度範圍內充電。 ▶ 假如在建議的溫度範圍內充電，指示燈仍在閃爍，請聯絡經銷商或客戶服務中心以作維修。
	即使在充滿電後，本產品亦只能使用數分鐘。	▶ 主機未正確插入充電座。	▶ 請查看主機是否豎直，讓底部接觸到充電座的充電插頭，且充電狀態指示燈已經亮起。 (請參閱第 30 頁。)
	▶ 電池已達到使用壽命(大約 3 年)。	▶ 請更換新電池。(請參閱第 39 頁。) ▶ 請聯絡經銷商或客戶服務中心。	

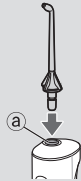
問題	可能成因	解決辦法
<b>使用時</b> 本產品無法運作。	<ul style="list-style-type: none"> <li>▶ 電池已達到使用壽命（大約 3 年）。</li> <li>▶ 本產品在大約 5 °C 或以下的溫度中使用。</li> </ul>	<ul style="list-style-type: none"> <li>▶ 請拆除內置充電電池。（請參閱第 39 頁。）請聯絡經銷商或客戶服務中心。</li> <li>▶ 切勿在在大約 5 °C 或以下的溫度使用本產品。</li> </ul>
水柱無力。	<ul style="list-style-type: none"> <li>▶ 噴嘴堵塞。噴嘴出口受到擠壓。</li> <li>▶ 過濾器堵塞。</li> </ul>	<ul style="list-style-type: none"> <li>▶ 請更換新噴嘴。</li> <li>▶ 請清除過濾器的污垢。（請參閱第 35 頁。）</li> </ul>
沒有水柱噴出。	<ul style="list-style-type: none"> <li>▶ 主機過於傾斜。</li> <li>▶ 可能需要耗費一段時間才能吸水。</li> </ul>	<ul style="list-style-type: none"> <li>▶ 請在主機豎立之後使用本產品。（請參閱第 32 頁。）</li> <li>▶ 請將水倒入噴嘴插入口<sup>Ⓐ</sup>，安裝噴嘴，然後開啟電源開關。</li> </ul> <div style="text-align: center;">  </div>
底蓋漏水。	<ul style="list-style-type: none"> <li>▶ 底蓋的橡膠部分積塵。</li> </ul>	<ul style="list-style-type: none"> <li>▶ 請清除積塵。（請參閱第 35 頁。）</li> </ul>
噴嘴難以安裝。	<ul style="list-style-type: none"> <li>▶ ▶ ▶ ▶ ▶ ▶ ▶</li> </ul>	<ul style="list-style-type: none"> <li>▶ 將清水倒入噴嘴插入口。</li> </ul>

如果仍然無法解決問題，請聯絡經銷商或客戶服務中心，以作維修。

## 電池壽命

大約 3 年。如果在充滿電的情況下，可使用次數仍然大幅下降，即代表電池壽命已經用盡。

（電池操作壽命可能會視乎使用情況或保存狀態而有所不同。）

## 棄置本電器

取出內置充電式電池後，方可丟棄本產品。

- 必須以安全的方式丟棄電池。
- 本圖解只供丟棄本產品時參考使用，不可作維修用途。
- 假如您自行拆解此產品，本產品將無法再防水，並可能會導致故障。

## 怎樣取出電池

- 在充電座和轉接器上取下本產品，按下電源開關開啟電源，然後持續開啟電源，直至電池電力耗盡為止。
- 取下底蓋。
- 執行步驟①至⑤拆解主機，然後使用螺絲批取下電池。
- 在⊕號和⊖號上貼上膠紙，讓接點絕緣（避免接點短路）。

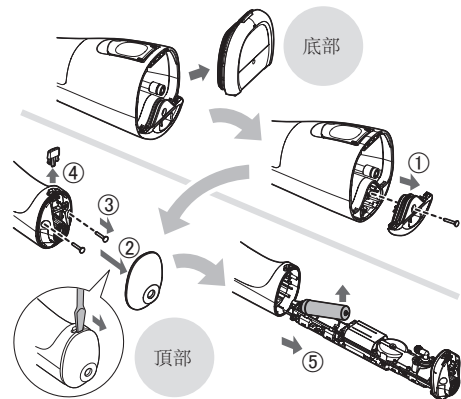

### 環境保護及資源回收

本產品含有鋰電池。

如果您所在的國家或地區有指定認可的電池棄置地，請確保將電池棄置於這些地方。

## 規格

電源	請參閱產品上的標示 〔自動變壓〕
充電時間	大約 1 小時
操作時間	級別 5： 大約 10 分鐘 (徹底充電時，溫度為 20 °C)
水箱容量	大約 200 mL (水壓級別設定為 5 時， 可運作大約 60 秒)
外形尺寸	主機：210 (高) × 75 (闊) × 85 (深) mm (不包括噴嘴) 充電座：40 (高) × 90 (闊) × 100 (深) mm
重量	主機：大約 275 g (包括噴嘴) 充電座：大約 115 g

此產品只適合家居使用。

## 更換噴嘴 (須另行購買)

### ► 超聲波噴嘴

- 如果噴嘴尖端已經變形，請更換新的噴嘴。
- 噴嘴即使形狀無變，基於衛生理由，也應每 6 個月更換一次。



新的噴嘴 (尖端)



變形 (磨損) 的噴嘴 (尖端)

### ► 矯齒噴嘴

- 大約每 3 個月更換矯齒噴嘴。若刷毛鬆曲，即使刷頭使用不足 3 個月，也應更換刷頭。

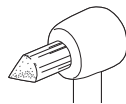

新的噴嘴 (尖端)



刷毛鬆曲的噴嘴

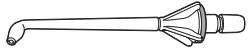
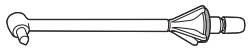

部件號碼	為 EW1513 更換噴嘴	
WEW0983	超聲波噴嘴	
WEW0984	矯齒噴嘴	



# MEMO

---

---

---

---

---

---

---

---

---

---

---

---

---

---

---

---

---

---

---

---

---

---

Panasonic Corporation  
<http://www.panasonic.com>  
© Panasonic Corporation 2021