

Panasonic®

Operating & Installation Instructions

Tumble Dryer
(Household use)

Model No.
NH-S7NC1

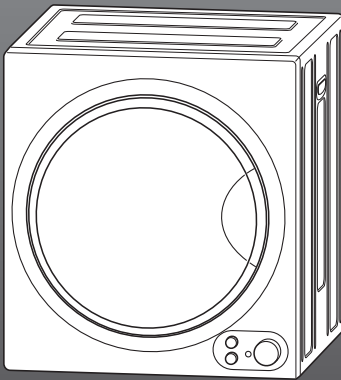

Contents

Safety Precautions	2
Part Names	5
Things that cannot be dried	5
Drying	6
Maintenance	6
Troubleshooting	8
Installation	8



It is essential to read these instructions.

Thank you for purchasing this product.

- Read these instructions carefully for optimum performance and safety before use.
- Keep this manual for future reference.

Specifications

Rated voltage (V)	220
Rated frequency (Hz)	50
Rated power (W)	1440
Product dimensions (W x D x H) (mm)	600 x 545 x 680
Product weight (kg)	25
Maximum mass of dry cloth (kg)	7.0

Panasonic Corporation

<https://www.panasonic.com>

© Panasonic Corporation 2024

AWH9901A0AA0-0A0

A0324-0

Printed in China

03-2024

Safety Precautions

! WARNING

May cause serious injury or death

Children must not use it alone

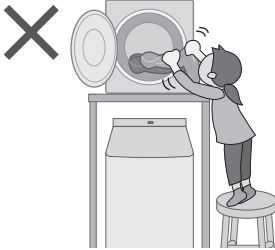

- This appliance is not intended for use by persons (including children) with reduced physical, sensory or mental capabilities, or lack of experience and knowledge, unless they have been given supervision or instruction concerning use of the appliance by a person responsible for their safety.
- Children should be supervised to ensure that they do not play with the appliance.
- Do not leave a stool, etc., near the appliance.
- Do not hang from the appliance.

May cause fire, electric shock, or failure

Do not touch it with wet hands



Do not hold or pull on the cord

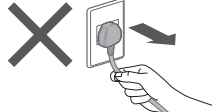

Fully insert it

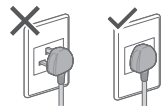

Do not use

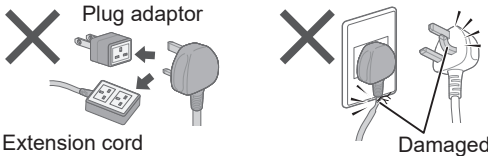

Do not bind, twist, or bend



Do not pinch the power cord by the dryer stand or the appliance

- If the power cord is damaged, it must be replaced by the manufacturer, its service agent or similarly qualified persons in order to avoid a hazard.

Securely insert the ground prong. Ask the electrical technician for a new socket

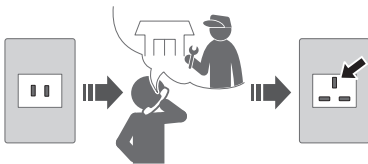

In case of failure or damaged power cord, stop use and ask the electrical technician

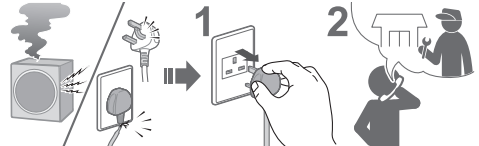

Use a socket appropriate for this appliance

e.g.)

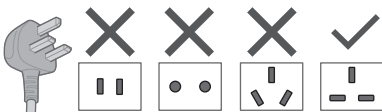

- The plug shape, socket shape and rating requirement vary with the region.

Accumulated dust may cause fire

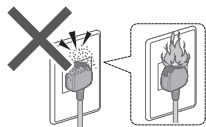

Wipe the power plug periodically



Keep away from flammable materials



Do not disassemble, repair or modify it by yourself

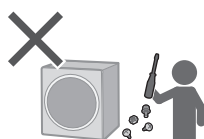

Do not dry items soiled with flammable materials.



- Items that have been soiled with substances such as cooking oil, acetone, alcohol, petrol, kerosene, spot removers, turpentine, waxes, wax removers and cosmetic oils must not be dried in the appliance even after having been washed.

Empty all pockets.

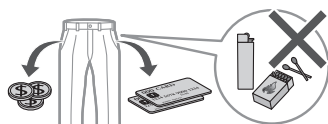

- Make sure that no objects are left in any of the pockets. Pay particular attention to cigarette lighters and matches. They may cause fire.

Do not dry items made of rubber, etc.

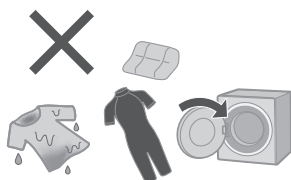

- Items such as foam rubber (latex foam), shower caps, waterproof textiles, airtight fabrics, rubber backed articles and clothes or pillows fitted with foam rubber pads should not be dried in the appliance. Such materials may be destroyed and thereby damage the appliance.
- Do not dry unwashed items in the appliance.
- Do not put in dripping wet clothing.

The lint must not be allowed to accumulate around the appliance.

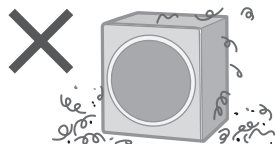

The lint filters have to be cleaned frequently.



Observe the following.

- Never stop the appliance before the end of the drying cycle unless all items are quickly removed and spread out so that the heat is dissipated.
- The appliance is not to be used if industrial chemicals have been used for cleaning.
- The appliance must not be supplied through an external switching device, such as a timer, or connected to a circuit that is regularly switched on and off by a utility.

Safety Precautions (continued)

! CAUTION

May cause failure or injury

Keep away from heat and direct sunlight.

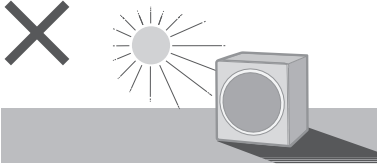

Do not obstruct.

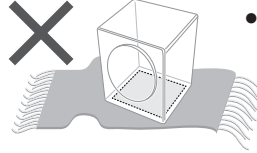

- Do not obstruct the openings of the bottom face with carpet, etc.

Be careful not to get your fingers caught.



Do not climb on the appliance.

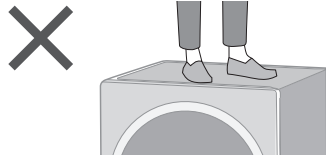

Do not touch when they are hot.

While operating and immediately after finishing

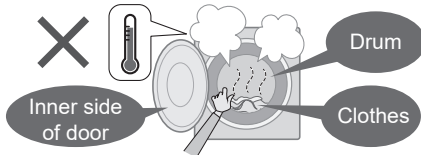

- Do not touch the clothes until the drum stops spinning.

Install the appliance correctly.

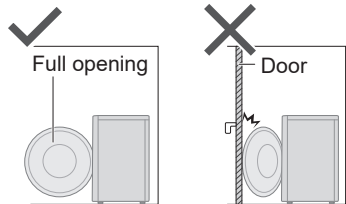

- The appliance must not be installed behind a lockable door, a sliding door or a door with a hinge on the opposite side to that of the appliance, in such a way that a full opening of the appliance door is restricted.

For machine-dryable items only.



Follow the instructions.



- Fabric softeners, or similar products, should be used as specified by the fabric softener instructions.

Secure the appliance when installed on a dryer stand. (P.8)

Part Names

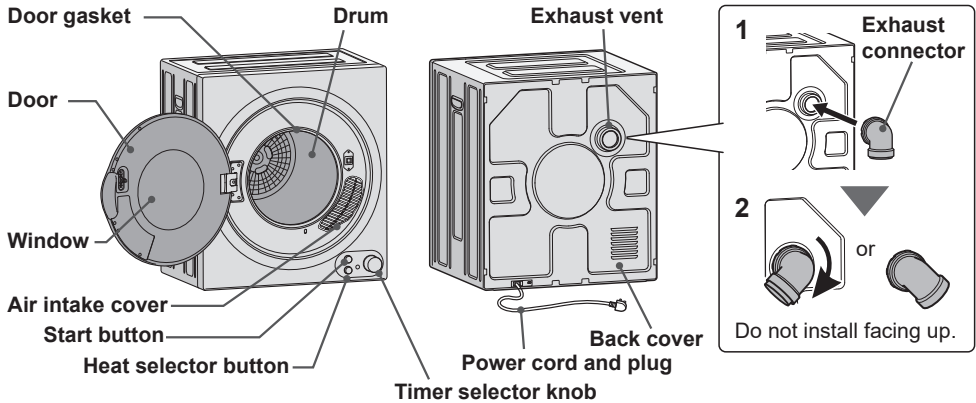

Accessories

Drying rack (1)
 Exhaust filter (2) (P.6)
 Exhaust connector (1) (See above.)
 Fixed clip (4) / Screw (4) (P.8)
 Leg (4) (P.8)

Insert
 Put in the inside

- For sports shoes and clothes that should not be spin-dried, etc. (Do not use for leather or plastic goods that are sensitive to heat.)

弱 Low (P.6)
 (High temperatures damage clothing)

Put horizontally
 Max: 2.2 kg

Things that cannot be dried

Woolen clothing, feather and other protein fibre materials	Leather / fur	Silk, rayon and cupro (Blended fabric)	Tights or pantyhose	Starched clothing	Any of the above marks
					Others ...
Mats and other items with hair of pets attached	Cushion, Pillow, etc.	Quilts	Urethane / rubber backed or thick mats	Clothing with lace or embroidery, new synthetic fibres, printed clothes, etc.	<ul style="list-style-type: none"> • Wrinkled and embossed articles • Crepe fabric • Deformable clothing (blazers, ties, dresses, etc.) • Velvet

NOTE

• May cause clothing deformation, damage and harm or malfunction to the appliance.

Drying

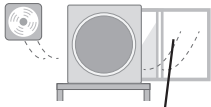

Check ventilation.

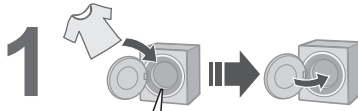

1

4 Start

2 "High" or "Low"

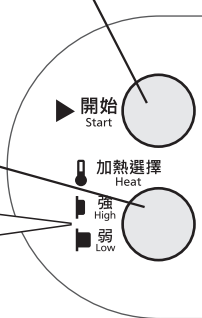

- 強 High Ordinary clothes
- 弱 Low Delicate items

3 Drying time

(Guide only)

Drying capacity (Approx.)	Drying time (Approx.)	
	High	Low
7.0 kg	200 min	—
4.5 kg	145 min	—
2.0 kg	80 min	130 min
1.0 kg	50 min	75 min

• Includes 20 min for Cool Down.

- Remove foreign objects.

- Use laundry nets for delicates.

- Close fasteners, hooks, and metal buttons, etc.
→ Turn the item inside out.

- Tie any strings.

- To prevent static electricity, use fabric softener when washing clothes.

- Spread out.

Maintenance

Appliance

If it gets dirty

Soft damp cloth

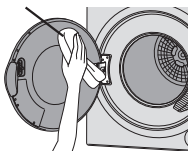

For heavy soil



NOTE

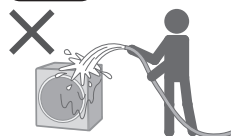

- Do not use gritty cleaners or thinners, or products containing alcohol or paraffin oil.

Lint filter, Exhaust filter

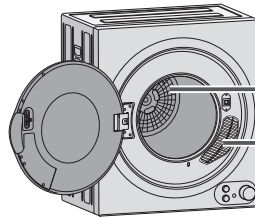

Air intake cover

Once a month

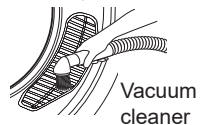

5 Finish

Air Dry
Refreshes clothes with air from the drum rotation. (no heating)

Cool Down

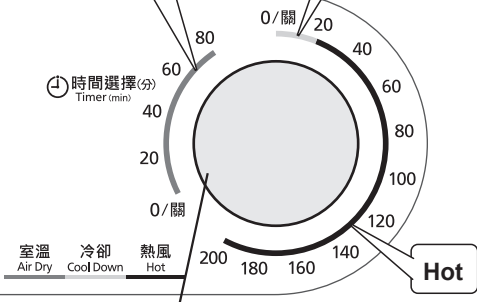

NOTE

- You can change the time during drying.
- To stop during drying
→
- To restart
→
- To set to 200 min (Hot) or 80 min (Air Dry),
→
move back a little.
- Drying results can be affected by many factors, such as material, bulkiness, how full the dryer is etc.

■ Approximate amount of clothing

800 g	• Work clothes (blended fabric)	
500 g	• Pyjamas (100 % cotton)	
400 g	• Skirt (synthetic fibres)	
300 g	• Bath towel (100 % cotton) • Sweater (blended fabric)	

200 g	• Dress shirt (blended fabric) • Blouse (blended fabric)	
130 g	• Long-sleeved underwear (100 % cotton)	
50 g	• Socks (blended fabric) • Briefs (100 % cotton)	

(Guide to weight per item)

• Weight varies depending on the material, etc.

After each use Not doing maintenance reduces drying performance.

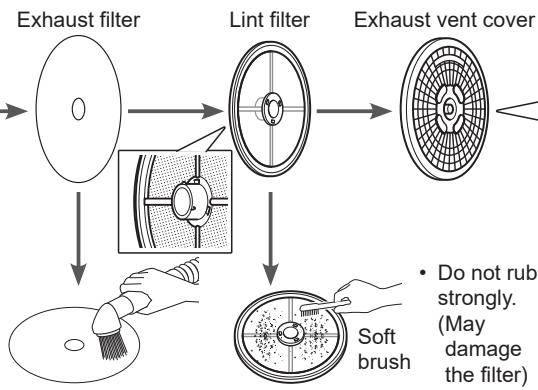

■ How to remove

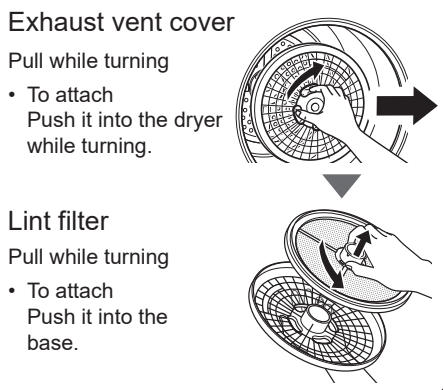

Troubleshooting

• Dryer does not start
• Drum does not turn

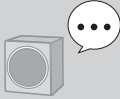

Check

- Power cut
- "0/關"
- Close the door.
- Fully insert.
- Set the dry time.

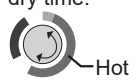
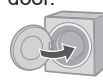

Try

Hot air is not blowing out



Possible cause

- Set to "Cool Down" or "Air Dry" ?



Cool Down

Try

- Set to "Hot".



• Drying is insufficient
• Drying is uneven



Possible cause

- During drying
- Set to "Air Dry" ?



Add clothes



Try

- Clean the filters. (P.6)
- Reduce clothing amount.
- Spin dry in a washing machine.



- Untangle clothes.



- Check the location.

See below.

If the trouble is not resolved, or an abnormality other than the above has occurred,



Installation

■ Check the location.

Be careful of inadequate ventilation.

Room temperature and humidity will rise during drying.

Please open the windows near the machine or turn ventilator during drying.

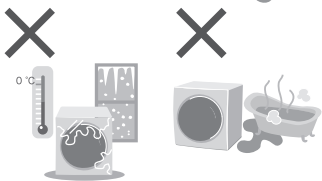
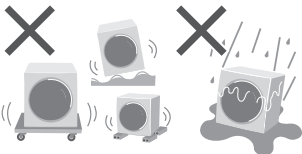

Make sure to ask a service person for installation.

- Do not install the appliance by yourself.
- Follow this installation method. If you do not, Panasonic will not be liable for any accidents or damages.

■ Set-in installation

10 mm
or more

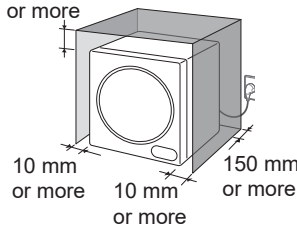

■ When installed on a dryer stand

The dryer stand (N-U168U) is sold separately.

- See the Installation Instructions for the dryer stand.

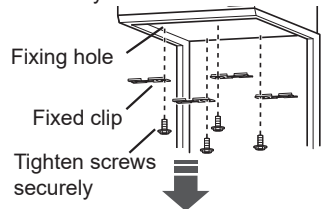

■ When not installed on a dryer stand

