

Panasonic®

ENGLISH
OPERATING INSTRUCTIONS

ROOM AIR CONDITIONER
CW-V715JA/CW-V915JA

ACXF550088



Before operating the unit, read these operating instructions thoroughly and keep them for future reference.

Thank you for buying Panasonic Air Conditioner

1 SAFETY PRECAUTIONS

Please observe these following safety precautions when using your air conditioner.

- Failure or negligence in observing these safety precautions could cause fire, electrical shock or personal injury.



WARNING This sign warns of risk of death or serious injury.



CAUTION This sign warns of risk of injury or damage to property.



This symbol (with a white background) denotes an action that is **PROHIBITED**.



These symbols (with a blue background) denote actions that are **COMPULSORY**.

2 INSTALLATION PRECAUTIONS



Do not install, remove and reinstall the unit yourself.

Improper installation may cause leakage, electric shock or fire. Please engage an authorized dealer or specialist for the installation work.

Do not add or replace refrigerant other than specified type.

It may cause product damage, burst and injury etc.

If the supply cord is damaged, it must be replaced by the manufacturer, its service agent or similarly qualified persons in order to avoid a hazard.



The room air conditioner must be earthed.

Improper grounding could cause electric shock.

Do not install the unit in a place where there are explosive gas leaks.

Gas leaks near the unit could cause fire.

Ensure that the drainage piping is connected properly.

Otherwise, water will leak out.

3 OPERATION PRECAUTIONS



WARNING This sign warns of risk of death or serious injury.



- Do not modify the length of the power cord or use an extension cord.
- Do not touch or operate with wet hands.
- Do not modify or damage the cord.
- Do not turn on the unit by inserting the power plug. Do not switch off the unit by pulling out the power plug.
- Avoid an extended period of direct airflow.
- Do not insert your fingers or other objects into the unit, rotating parts may cause injury.
- Do not try to repair the unit yourself. Engage authorized dealer or specialist for installation.



- Plug in the P.S. cord properly before operating and use a specified power cord.
- If abnormal conditions (burnt smell, etc.) occur, switch off and unplug the unit.
- Confirm to authorized dealer or specialist on usage of specified refrigerant type. Using of refrigerant other than the specified type may cause product damage, burst and injury etc.
- This appliance is not intended for use by persons (including children) with reduced physical, sensory or mental capabilities, or lack of experience and knowledge, unless they have been given supervision or instruction concerning use of the appliance by a person responsible for their safety. Children should be supervised to ensure that they do not play with the appliance.



CAUTION This sign warns of risk of injury or damage to property.



- Do not use the unit for other purposes, than its intended use.
- Do not remove the power plug by pulling the cord.
- Do not block the air intake and outlet vanes.
- Do not splash or direct water at the unit.
- Do not expose the unit to direct sunlight during operation.
- Do not operate the unit without the air filter installed or when the front intake grille has been removed.
- Do not place any objects on the unit.
- Do not operate any combustion equipment near the unit's airflow area.
- Do not sit or step on the unit, you may fall down accidentally.
- Do not touch the sharp aluminium fin, sharp parts may cause injury.



- Switch off the breaker and unplug the unit from the socket if the unit will not be operated for a long period.
- Pay attention to any damages on the unit caused by extensive usage.
- Ventilate the room occasionally where the unit is installed.
- Unplug the power cord when cleaning the unit.

4 PART IDENTIFICATION

MAIN UNIT

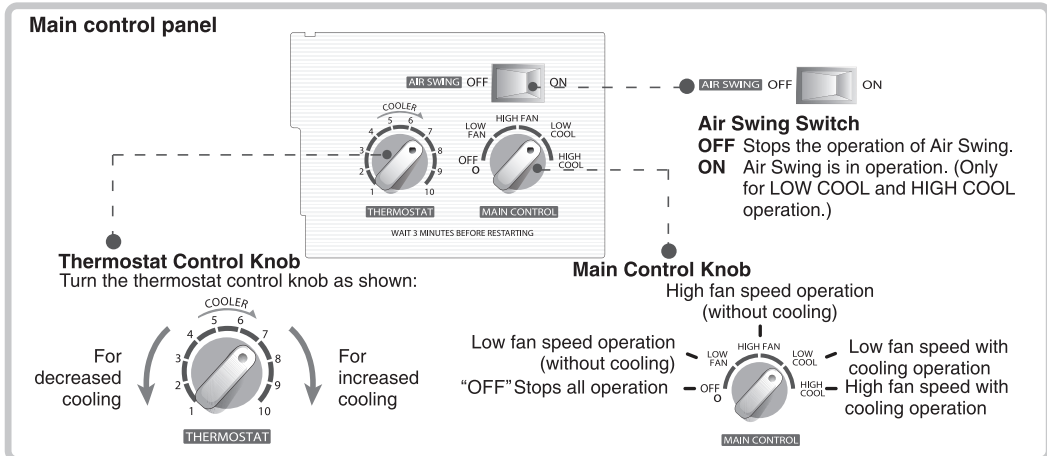
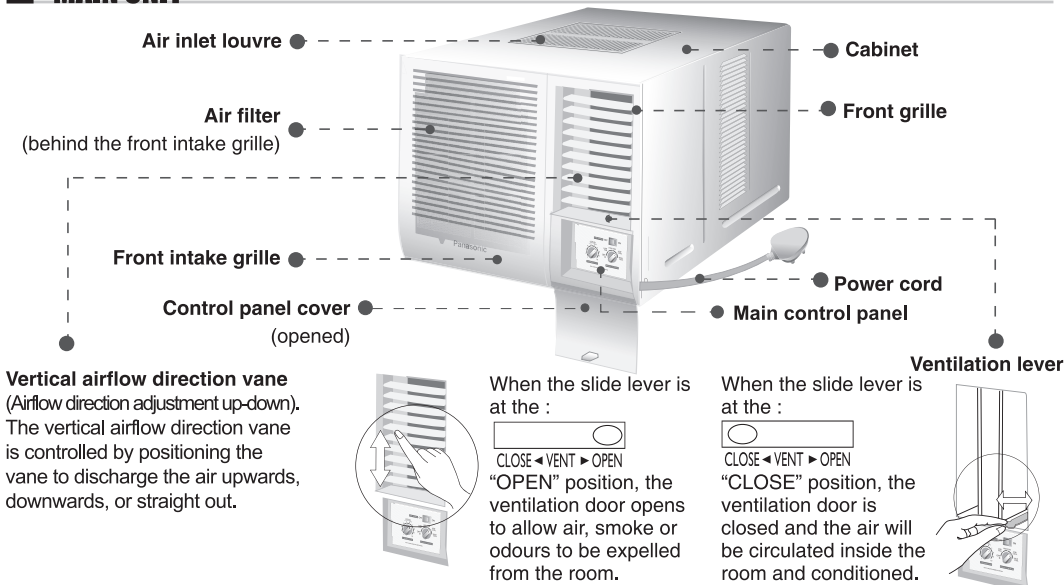

5 AIR CONDITIONER OPERATION

OPERATION CONDITIONS

Use the air conditioner under the following conditions:

- Operating temperature range.

(unit in °C)

	Indoor side		Outdoor side	
	D.B.T.	W.B.T.	D.B.T.	W.B.T.
Max. Temperature	32	23	43	26
Min. Temperature	21	15	21	15

D.B.T.: Dry Bulb Temperature
W.B.T.: Wet Bulb Temperature

NOTE: Humidity may exceed 90%

Continuous operation at over 90% high humidity may create condensation and result in waterdrops on the intake and outlet vanes.

1



Open the control panel cover.



CAUTION

Switch off the breaker and set the main control knob to the OFF position before plugging the power plug into an electrical outlet.

2



Main Control Knob.

Set to LOW COOL or HIGH COOL as desired. (FAN setting operates the fan only.)

Caution: If the main control knob is turned off or changed to a fan setting from a cooling operation setting, WAIT at least 3 minutes before resetting to cooling operation.

3

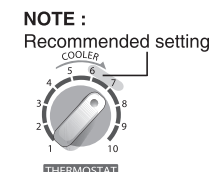

Thermostat Control Knob.

- For a room that is too warm, set the control knob to a clockwise direction.
- If the room is too cool, set the control knob to a counter clockwise direction.
- NOTE :** Usually 6 ~7 is the recommended setting position.

4



Air Swing Switch.

(Airflow direction adjustment Side-to-Side)

To obtain a fix airflow direction, set the air swing switch to "ON" for the vanes to swing from side to side until the desired flow direction is reached, then switch it to "OFF".

For continuous side-to-side air circulation, set the air swing switch to "ON".

6 AIR CONDITIONER INSTALLATION

CHOOSING THE INSTALLATION LOCATION

- When installing, use the nearest power outlet. Make sure the power outlet is easy to reach so you can quickly disconnect your air conditioner in case of emergency.
- Ensure that the air conditioner is well supported, securely fastened, easily reachable and not obstructed.
- Avoid locations with: salty or sulphurous air, draughts, dampness and flammable gas.
- If you install the drainage system, be sure to channel the condensed water to a suitable location.
- Covers, obstructions and unsteady support may cause excessive operating noise and vibration.
- The rear end of the air conditioner is splash proof. You need not shield or cover it.

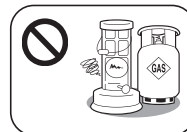

PREPARATIONS BEFORE INSTALLATION

Dimension

- There should not be any obstacles surrounding the unit.
- Prepare an installation hole slightly bigger than the cabinet size.
- Left and right sides of the unit should be at least 15cm away from the wall.

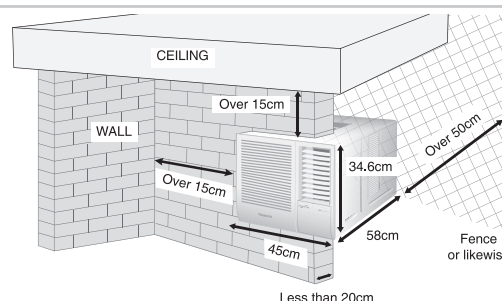

CAUTION POINT DURING INSTALLATION

When installing air-conditioner at glass window or thin partition, fix the vertical & side supporting bar to the concrete wall in order to support the weight of the air-conditioner and reduce the vibration that is being transferred to the glass window or thin partition.

This can minimize the noise problem caused by improper installation.

- Proposed to use 1/8" x 1-1/4" "angle-aluminium" for installation frame and side supporting bar.

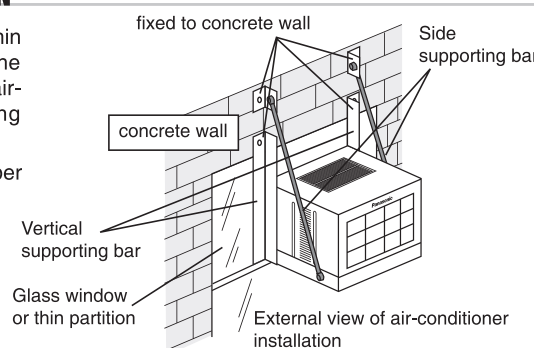

REMOVAL OF FRONT GRILLE

1

- Remove the front intake grille.
Pull up the front intake grille about 90° and slide it slightly to the left to unhook the tabs. Unhook string for intake grille.



CAUTION

Do not raise the front intake grille any higher than 90° to the unit or damage to the tabs may occur.



2

- Remove the air filter.
Tilt up and pull out the air filter by the holder.

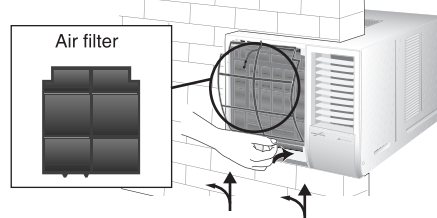

3

- Remove the front grille.
 - Remove the screw on the front grille.
 - At bottom right side of the front grille, press inward on cabinet near the power cord, and pull the grille outward to the right until right tab releases.
 - At the bottom left side, push inward on cabinet and pull the grille outward to the left to release the left tab. Do not pull the bottom edge toward you more than 3 inches to prevent the two top tabs from damage.
 - Slide the front grille upwards to loosen the two top tabs from slots at the top of the cabinet.

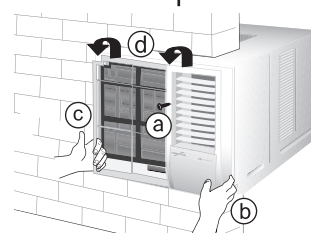

4 AIR CONDITIONER INSTALLATION

■ INSTALLATION PROCEDURES

- 1 Remove the rear cabinet screws and chassis locking bracket from the cabinet. Save for later use.
- 2 Slide the chassis out from the cabinet.

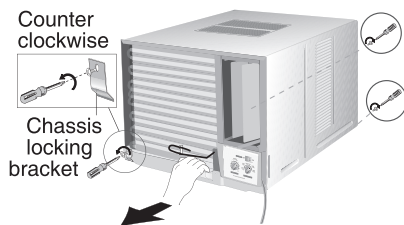

- 3 Place cabinet into the installation hole.

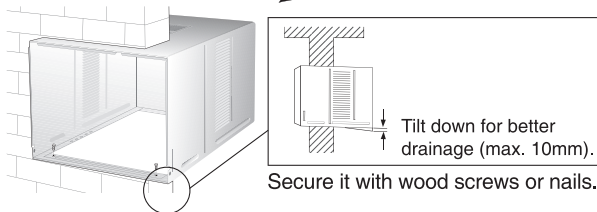

- 4 Before installation, please remove the Shipping Block at front side of unit and Shock absorber at the Compressor top, Accumulator and receiver. Filament tape fixed to the compressor and Copper tube, and also remove connecting bar. (refer to caution label)

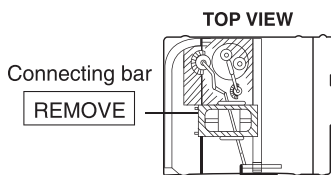

- 5 Slide the chassis into the cabinet.
- 6 Lock the chassis to the cabinet reusing the chassis locking bracket.

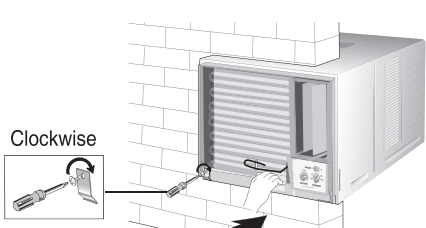

- 7 Depending upon the location of the AC outlet, route the AC cord to either the left or right side while installing the front grille.

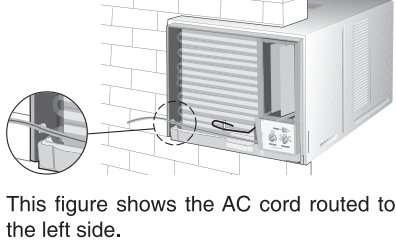

- 8 Attach the front grille to the cabinet and fasten it with screws.

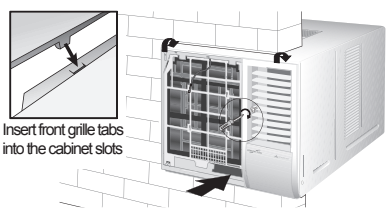

- 9 Attach air filter to the front grille. (See anti-bacterial filter installation instructions included in this package)

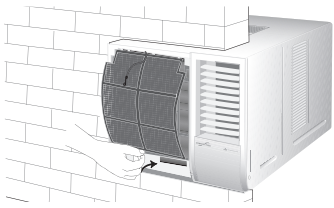

- 10 Insert hook of string in the hole provision of the intake grille. Slide the front intake grille slightly to the right to reattach the tabs and then push it down to close tight.

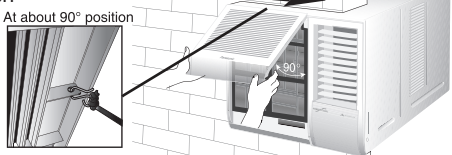

■ CONDENSED WATER DRAINAGE

This air conditioner employs a "Slinger-Up System" which is designed to splash the condensed water on the condenser coil for maximum cooling efficiency, thus producing a splashing sound. If the splashing sound annoys you, you can provide an outside drainage by using the following procedure which may, however, cause a small loss of performance.

NOTE: If the unit is installed at coastal area, drainage of condensed water is recommended to prevent the condenser being corroded easily.

- 1 Remove the rubber plug and chassis locking bracket from the cabinet. Then slide the chassis out from the cabinet.

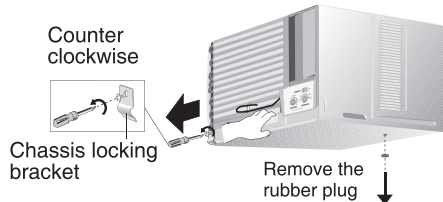

- 2 Install the drain pan.

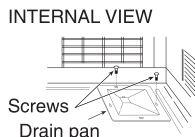

Install the drain pan at the right corner of the cabinet using 2 screws.

- 3 Connect a drain hose. Fit the drain hose to the drain pan.

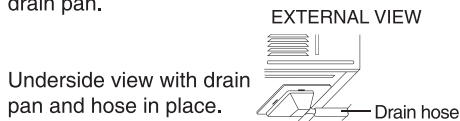

NOTE: Drain hose or tubing can be purchased locally to satisfy your particular needs.

- 4 Slide the chassis back into the cabinet. Lock the chassis to the cabinet reusing the chassis locking bracket.

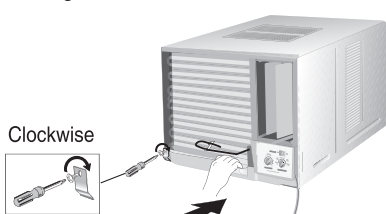

■ ELECTRICAL WORK

- Always use at the rated voltage and with a specific air conditioning circuit.
- This equipment must be earthed and strongly recommended to be installed with Earth Leakage Circuit Breaker (ELCB) or Residual Current Device (RCD). Otherwise, it may cause electrical shock or fire in case of malfunction.
- A 16 Ampere time delay fuse or circuit breaker is required.
- Nominal cross sectional area of power supply wire must be 3 core x 1.5 mm² or above.
- The power supply must be from an independent circuit.
- All electrical installations must be made in accordance with local wiring and safety regulations wherever applicable.
- There must be a double pole switch with a minimum of 3.5 mm contact gap in the fixed installation circuit. (Applicable for models without power supply plug only.)
- Please engage an authorized dealer or specialist for the installation work.

■ NOISE CONSIDERATION

- Select an installation location that can support the weight of the air conditioner and one that will not cause increased operating noise and vibration.
- Ensure that airflow and noise from the rear side of the unit (outdoor) when installed do not disturb neighbouring residents.
- Obstacles placed in front of the air outlet on the rear side of the unit (outdoor), or covers placed over it will cause excessive noise and deterioration in performance.

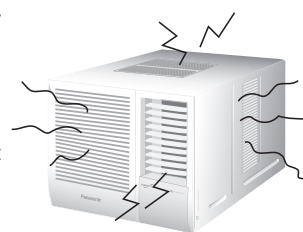

■ TRANSFERRING

- Repositioning or transfer of the air conditioner due to renovation or moving requires an additional service charge. Please consult your dealer before moving.

5 ENERGY SAVING HINTS

- Do not overcool the room. This may affect your well-being as well as increase power consumption.
- The cooling capacity of the room air conditioner must match the room size for efficient and satisfactory operation.
- Keep all doors and windows closed. Prevent hot air from entering and cool air from escaping.
- Ensure that curtains and drapes are always closed to keep out direct sunlight during cooling operation.
- Avoid heat.
- Clean the air filter every 2 weeks. Dirty filters may reduce cooling efficiency.

6 CARE AND MAINTENANCE

WARNING

Always turn off the air conditioner and the main power supply before clean the unit.
Switch off the power supply if the unit is not going to be used for a long period of time.

- Clean the cabinet, front grille with a mild soap or detergent and lukewarm water.
- The front intake grille can be easily removed for cleaning purposes (refer to **Remove the front intake grille** procedures). Gently wash it with water and a sponge.
- The filter can be easily cleaned using a vacuum cleaner. Vacuum the front of the filter and then wash the rear with water. If it is badly soiled, wash with a mild household detergent.
- Do not clean with benzene, thinner, scouring powder or cloth soaked in caustic chemicals.
- If the unit is extremely dirty, heat transfer is less efficient and the unit may not cool effectively. Please contact Shun Hing Electric Service Centre Ltd. for an annual check. (Annual check is not covered under warranty)
- If the air filter becomes clogged with dust, the cooling capacity will drop, and 6% of the electricity used to operate the air conditioner will be wasted.

NOTE: Do not dry the front panel or the air filter in direct sunlight. (Exposure to direct sunlight may discolour or deform the panel.)

■ PRE-SEASON INSPECTION

- *Is the discharged air cold?*
After 15 minutes of operation, it is normal for the temperature difference between intake and outlet air to be more than 8°C for cooling.
- *Are the air intake and outlet vanes of the indoor and outdoor side obstructed?*

■ RECOMMENDED INSPECTION

- Usage over several seasons will reduce performance as the unit becomes dirty. A dirty unit may produce foul odours and dust may clog the dehumidifying drainage. Seasonal inspection is recommended in addition to regular cleaning. Consult Shun Hing Electric Service Centre Ltd..

7 BEFORE CALLING FOR SERVICE

BEFORE

Check the following points before calling for repairs or service. If the malfunction persists, please contact Shun Hing Electric Service Centre Ltd..

Condition 1 If the unit is too noisy during operation.

The following sounds are normal during operation:

- A low humming sound indicating that the unit is operating.
- A soft clicking sound when the compressor turns on and off.
- A flowing sound due to circulation of the refrigerant when the compressor is turned on.
- A splashing sound indicating condensation in the condenser coil.

If you hear other noises, please consult Shun Hing Electric Service Centre Ltd..

Condition 2 If the unit does not operate.

- The main power cord is not plugged in.
- The main circuit breaker has tripped.

Condition 3 If the unit does not cool properly.

- The thermostat control knob is set at below 6.
- The room is too big for the unit's cooling capacity.
- The ventilation lever is set to OPEN.
- The air circulation is impeded by curtains or furniture.
- After 15 minutes of operation, it is normal for the temperature difference between intake and outlet air to be more than 8°C for cooling.

Condition 4 If water drips off the rear of the unit.

- Humidity is high.
- Condensed water is overflowing.
- To rectify the problem, mount an optional drain pan to the unit.

Condition 5 If water drips inside the room.

- The unit is tilted inward. To rectify this, tilt the unit slightly outward.
- Mount the drain pan if you prefer.
- The drain pan may be blocked.

Information for Users on Collection and Disposal of Old Equipment and used Batteries

[Information on Disposal in other Countries outside the European Union]
These symbols are only valid in the European Union. If you wish to discard these items, please contact your local authorities or dealer and ask for the correct method of disposal.

Note for the battery symbol (bottom two symbol examples):
This symbol might be used in combination with a chemical symbol. In this case it complies with the requirement set by the Directive for the chemical involved.

To call Shun Hing Electric Service Centre Ltd. IMMEDIATELY

Turn off the power and contact Shun Hing Electric Service Centre Ltd. as soon as any of the following events occur.

- The circuit breaker frequently trips.
- If water or foreign objects have accidentally entered the air conditioner.
- If there is abnormal sound during operation.

NOTE :

1. The enclosure opposing the room side is splash proof (IPX4).
2. Do not install this appliance in a laundry room or other locations where water may drip from the ceiling, etc.
3. If the supply cord is damaged or need to be replaced, it must be replaced by the manufacturer or its service agent or a similarly qualified person in order to avoid a hazard.

Panasonic Corporation
Website: <http://www.panasonic.com>

ACXF550088

Printed in Philippines
OFTH0810-00



4 空調器的安裝

■ 安裝之步驟

- 1 從機殼取出後機殼螺釘和底盤鎖定支架並保存以備日後使用。
- 2 把底架從機殼滑拉出來。

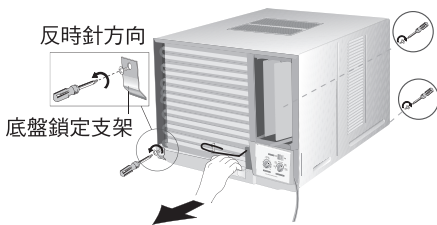

- 3 放置機殼在安裝洞內。

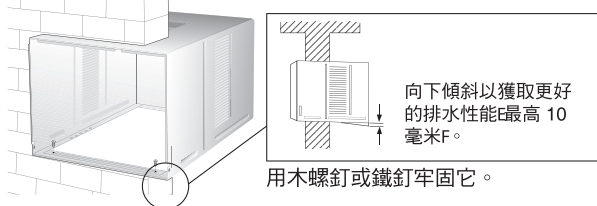

- 4 請於安裝前、拆除機前、銅管旁、壓縮機旁及上部的避震器。同時也拆除纖維膠帶及連杆。（參考注意標籤）

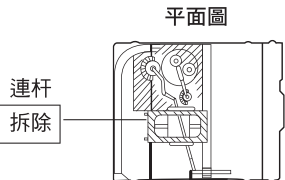

- 5 將底架放回機殼。

- 6 用底盤鎖定支架將底盤緊固於機殼。



- 7 在安裝面板時，交流電線可以繞向左邊或右邊，視交流電源出口的位置而定。

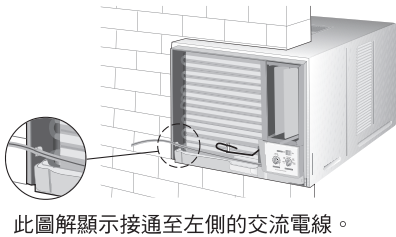

- 8 安置面板於機殼並用螺釘擰緊。



- 9 安置空氣過濾網於面板。（請參閱此包裝內的抗菌濾塵網安裝說明）

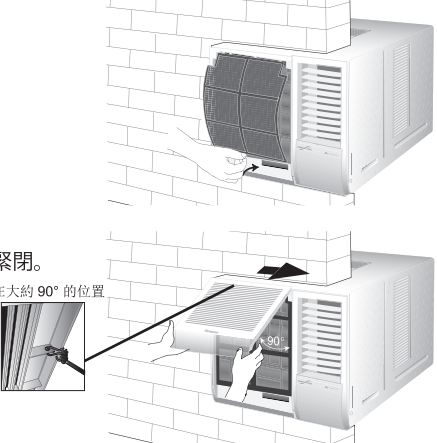

- 10 將串鉤插入進氣網的洞孔。稍微將正面進氣網往右移以扣入阻片，然後向下按壓即可緊閉。

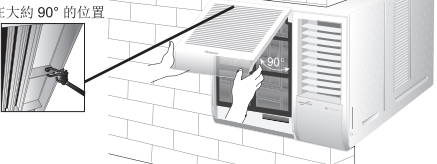

■ 冷凝器排水系統

本機採用將冷凝水噴灑在冷凝器上的設計，以取得最佳的制冷效能。這種方法稱為“甩擲系統”。如果噴灑的聲音令您覺得討厭，您可以採用以下方法進行室外排水，不過這會導致性能稍微減低。

備注：若安裝本機於海邊，我們建議您設置冷凝器排水系統以免冷凝器被快速腐蝕。

- 1 將底盤的橡膠塞子取走和拆除底盤鎖定支架。接着，把底架從機殼滑拉出來。

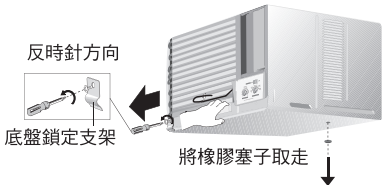

- 2 安裝排水盤。

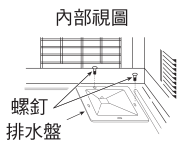

用兩個螺釘將排水盤安裝於機殼的右角。

- 3 安裝排水管。將排水管固定於排水盤。

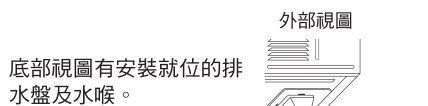

備注：您可按照個人所須在當地購買排水管或水喉。

- 4 將底架放回機殼。然後用底盤鎖定支架將底盤緊固於機殼。重新安裝機殼於底盤。

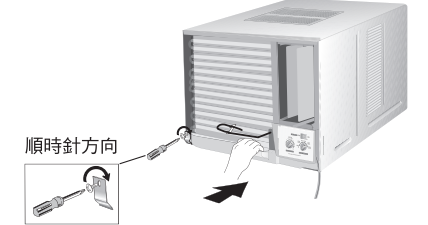

■ 電力裝置

- 請務必使用額定電壓和指定空調器電路圖。
- 本設備必須接地和安裝 ELCB 或殘餘電流裝置 (RCD)。否則在故障的情況下它可能會導致電擊或火患。
- 需要一個 16 安培的時間延遲保險絲或斷路器。
- 電源供應的電線地區分界額必須是 3 芯 x 1.5 平方毫米或更大。
- 電源必須來自一個獨立電路。
- 所有電機安裝工作都必須符合當地的電線和安全條例。
- 在固定安裝電路上必須設有一個接觸間隔不少於 3.5 毫米的雙極開關。（適用於沒有電源插頭的型式。）
- 請諮詢代理商有關於安裝的必要條件。

■ 噪音問題

- 應該選擇一個能承受空調器重量而又不會引起太多操作噪音和震動的安裝地點。
- 在安裝時應該確保本機後部（室外）的空氣流動和噪音不會對鄰居造成不便。
- 本機後部（室外）的空氣出口處如果有障礙物，或被物體蓋住，就會引起過度噪音和影響空調器性能。

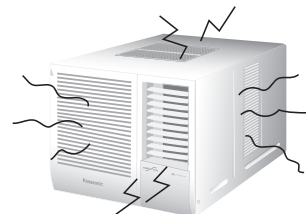

■ 搬運

- 如果由於裝修或搬運至其他地點而需要重新擺放空調器，這些拆卸和重新安裝的工作都必須支付額外的服務費，在搬運之前請先詢問代理商。

5 節省能量提示

- 不要使房間過冷。這對健康不利，而且浪費更多電力。
- 房間空調器的容量必需符合房間尺寸以獲得高效率 and 滿意運轉。
- 保持所有門窗緊閉。防止暖氣流入和冷氣流出。
- 制冷運轉時關上窗簾或布簾以避免直射日光。
- 隔離熱源處。
- 每兩個星期清洗空氣過濾網一次。骯髒的過濾網可能減低制冷效力。

6 保養及維修



警告

要拔出電插頭以清洗本機之前切記先關掉空調器和切斷電源。若長時間不使用本機，請關閉電源。



- 用溫和的肥皂或清潔劑配合溫水來清洗機殼和面板。
 - 您可輕易地拆卸正面入風口面板以進行清洗工作（請參考取下正面入風口面板步驟）。小心用水和海绵清洗。
 - 可使用吸塵器輕易清潔過濾網。抽吸過濾網正面的塵埃並用清水清洗其背部。若過於骯髒，請使用溫和家用清潔劑來清洗。
 - 切勿使用苯劑、稀釋劑、潔亮劑或用沾有腐蝕性化學劑的布料來清洗本機。
 - 若主機極度骯髒，散熱功能將減退，而主機可能無法發揮有效的制冷運轉。請諮詢信興電器服務中心有限公司以進行每年定期檢查。（每年檢查不受保於保修服務）
 - 若空氣過濾網累積塵埃，制冷效能將減退，亦浪費大約 6% 用於操作空調器的電力。
- 備注：切勿將面板或空氣過濾網直接放在太陽底下曬乾。（這將造成褪色或歪曲。）

■ 換季前檢查

- 吹出空氣是否涼爽？開始操作的 15 分鐘內，空氣吸入口及吹出口的溫度差距多過 8°C 是正常的。
- 室內或室外機的空氣吸入口和吹出口是否受阻？

■ 檢查建議

- 使用超過數季後主機將變髒而減低其效能。視運轉狀況而定，骯髒的主機可能散發異味，而塵埃將阻塞抽濕系統。除了定期清洗之外，我們也建議每季檢查。請諮詢信興電器服務中心有限公司。

7 要求維修服務之前

之前



在要求維修或服務之前，請先檢查下列各點。如果依然無法排除故障，請諮詢信興電器服務中心有限公司。

狀況 1 若主機在運轉當中過於吵鬧。

正常運轉當中可能檢測到以下聲音：

- 低弱嘯聲表示主機正在運轉。
- 當壓縮機開關時發出柔和卡嗒聲。
- 當壓縮機開動時因為冷媒循環而發出類似流水聲。
- 噴灑聲表示冷凝器正在冷凝。

若您聽到上述以外的噪聲時，請諮詢信興電器服務中心有限公司。

狀況 2 若主機無法操作。

- 沒有插入主電源線。
- 主電流斷路器跳掣。

狀況 3 若主機無法正常制冷。

- 室溫器開關掣設定水平低過 6。
- 房間太大以供主機的制冷效能。
- 通風換氣桿設定於 OPEN (開啟)。
- 窗簾或家具防礙空氣循環。
- 開始操作的 15 分鐘內，空氣吸入口及吹出口的溫度差距多過 8°C 是正常的。

狀況 4 若主機後部滴水。

- 濕度略高。
- 凝結的水溢出。
- 要糾正問題時，請附置排水盤於主機。

狀況 5 若房內滴水。

- 主機可能向內傾斜。請稍微向外調整以糾正傾斜。
- 可視個人所須裝上排水盤。
- 排水盤可能受阻。

關於用戶回收與表舊設備及電池的信息



【非歐共體國家的處理信息】
這些符號僅有效於歐洲共同體。如果您要丟棄這些物件，請諮詢您的當地政府或經銷商查詢正確的方式。

電池符號的注意事項（底部兩個符號舉例）：
此符號可與化學符號綜合使用。在此情況下，它須符合制定給該化學的使用條件。

立即洽詢信興電器服務中心

有下列任何事件發生時，請立即關掉電源並洽詢信興電器服務中心。

- 斷路器經常跳掣或保險絲經常燒斷。
- 如果不小心讓水或異物進入空調器。
- 運行時有不正常的聲音。

備注：

1. 相對於室內一側的封閉件為防濺結構 (IPX4)。
2. 不可將本機安裝在洗衣房或天花板滴水的地方等等。
3. 若電線已損壞或需要替換，它必須由製造廠家或服務代理商或擁有同等資格的人員進行替換以避免發生危害性事故。

Panasonic Corporation

Website: <http://panasonic.com>

ACXF550088

在菲律賓印刷

OFTH0810-00